

Campsite or Trail Boarder



Latrine



Tent Platform



Bridge



Part of trail not drawn for mapping purposes

The numbers drawn on maps depict Maximum Capacity for that area in the campsite. Example: 4-6 means 4 to 6 scouts or

2 to 3 tents.

For tent dimensions we used official BSA Scout tents 7' x 9'.

# Blackhawk

Many Point Lake

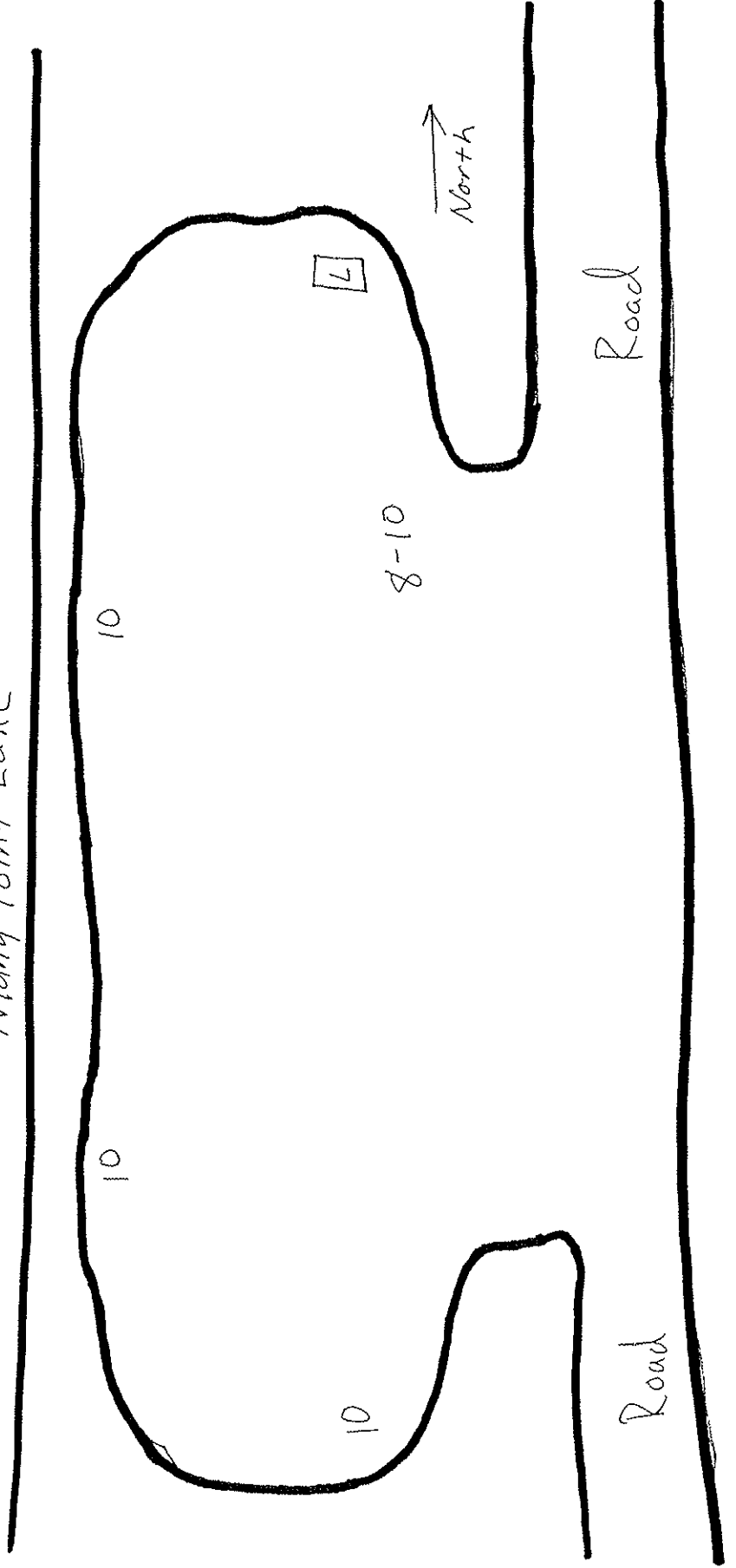

# Cochise

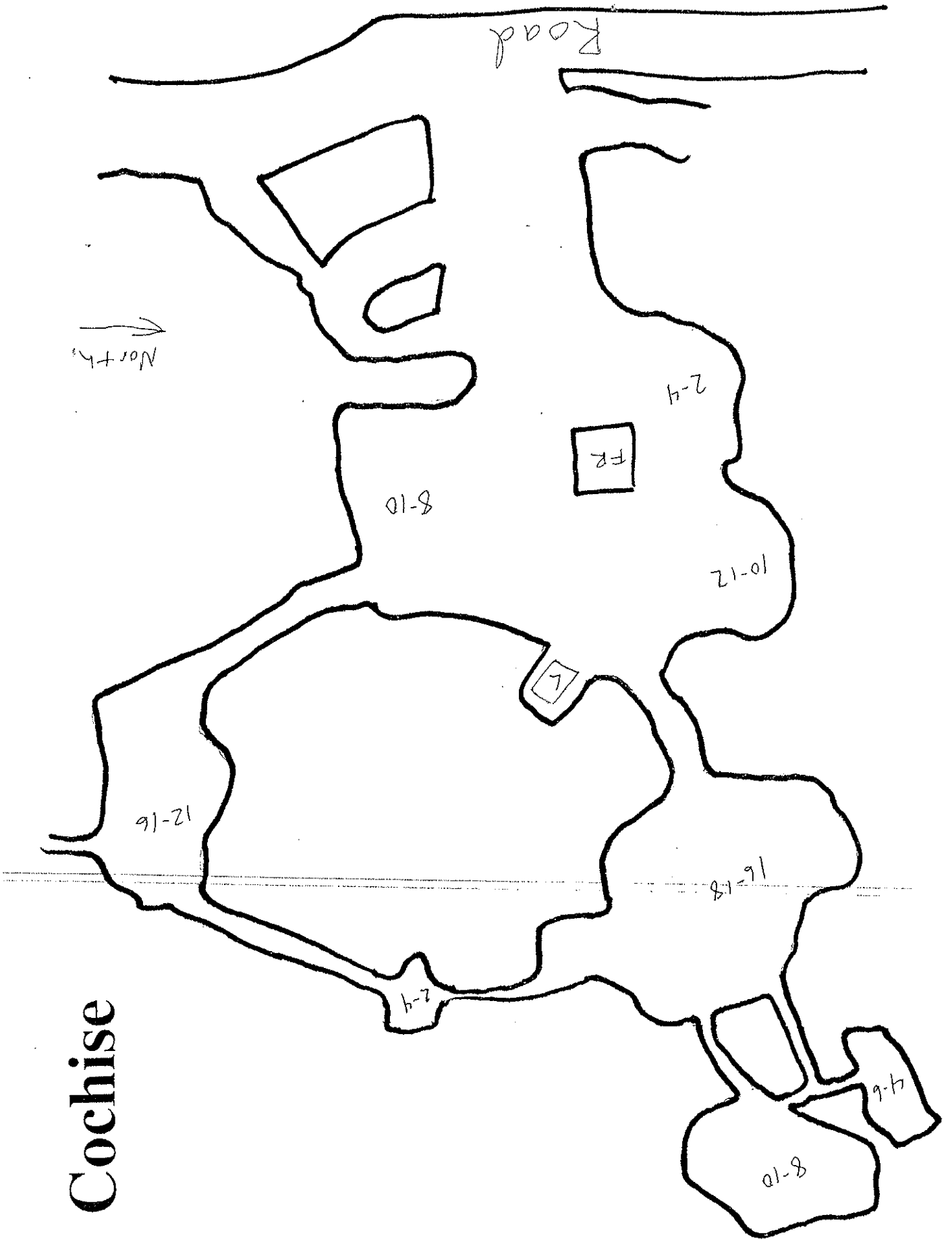

# Joseph

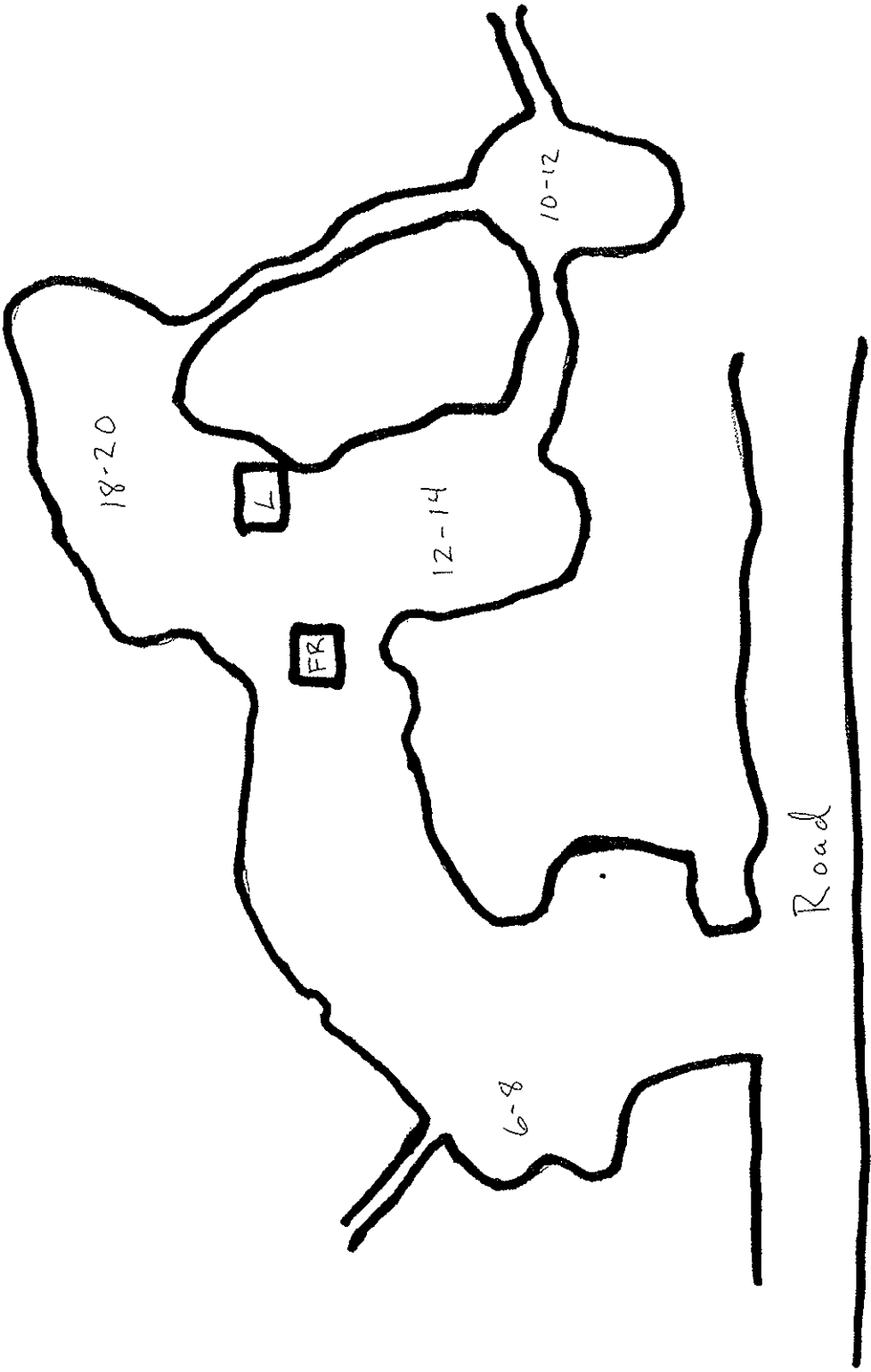

← North

# Massasoit

Many Point Lake

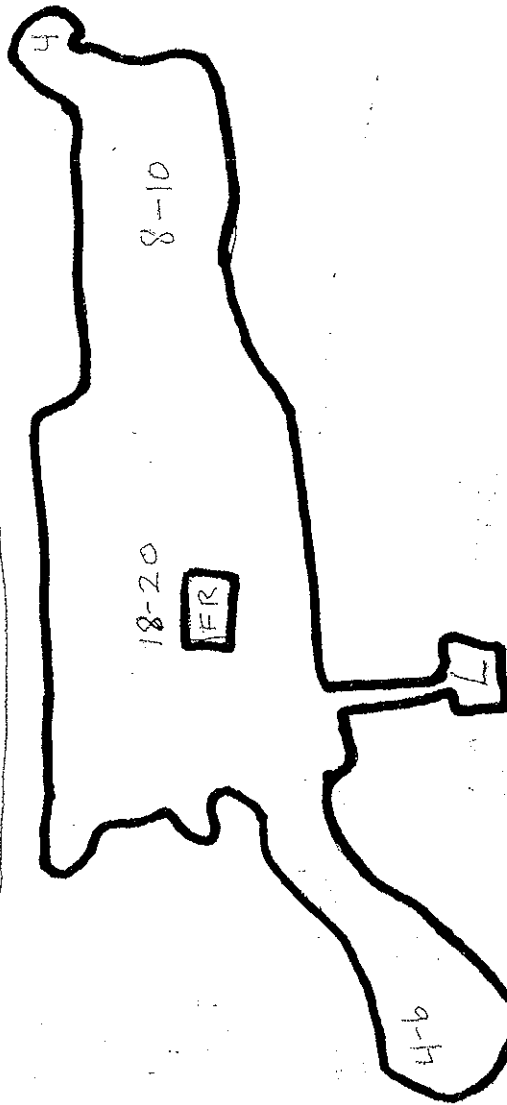

North

First Class Adventure  
Program Area

# Pontiac

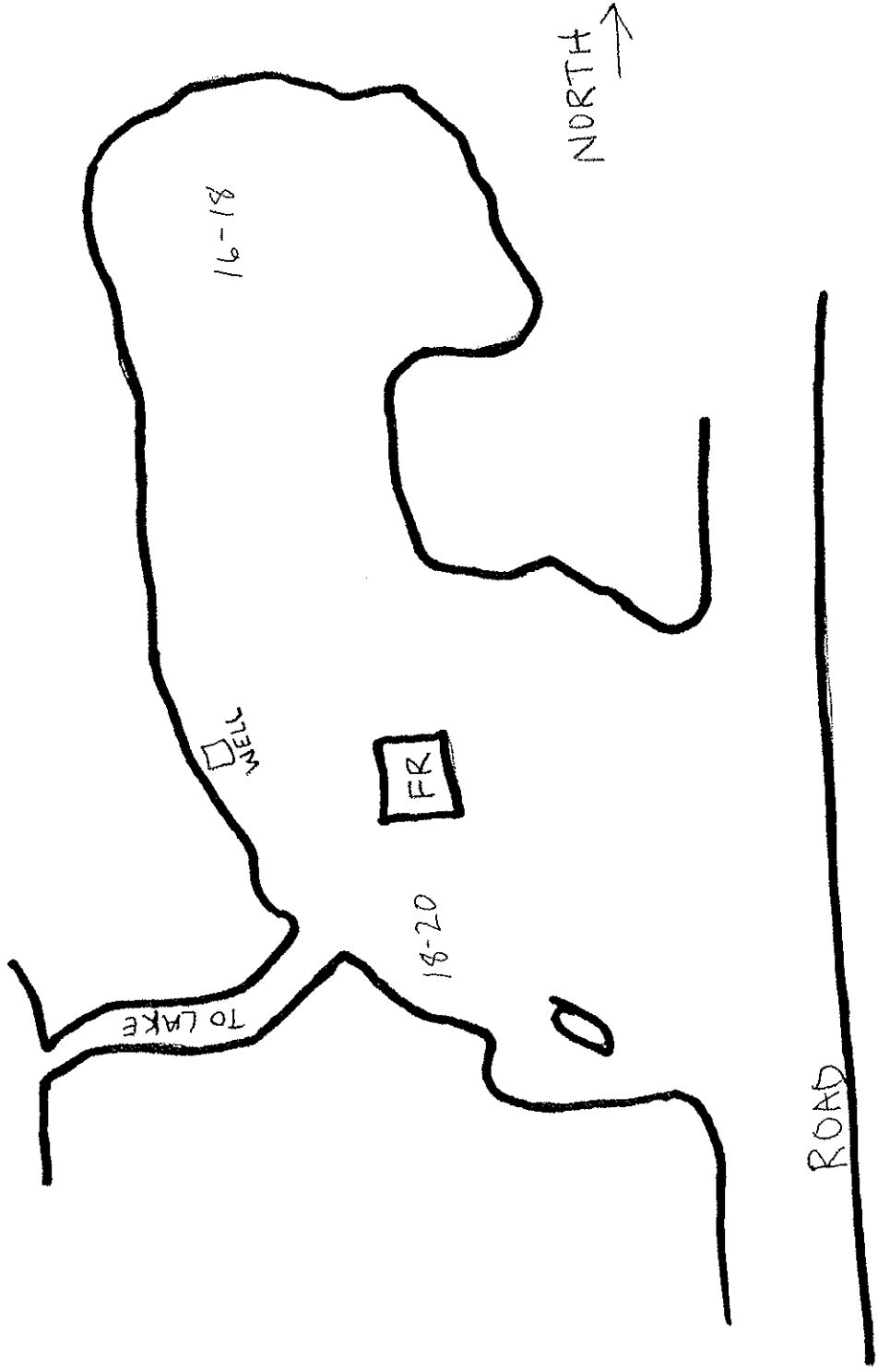

# Powhatan

Many Point Lake

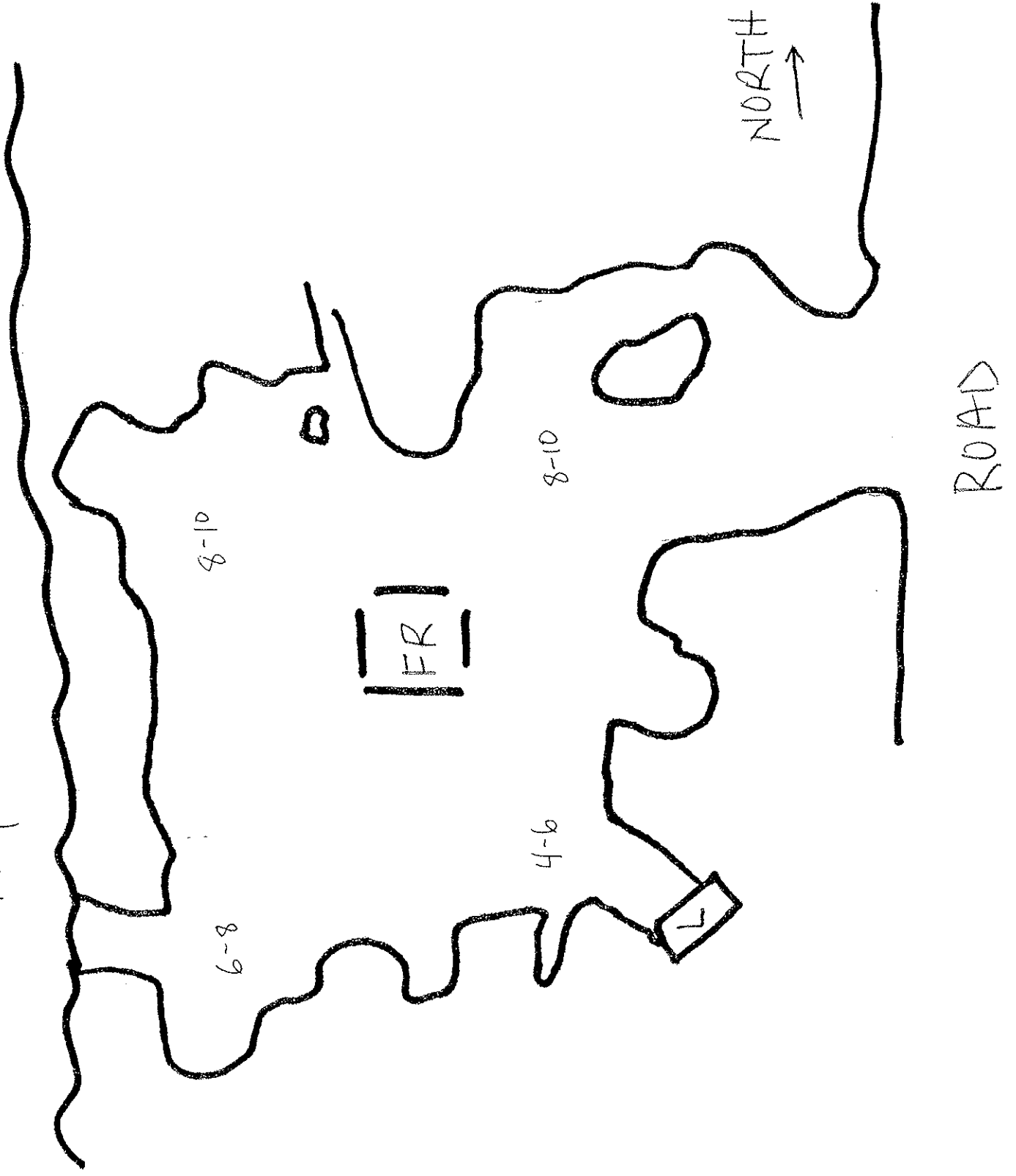

# Red Cloud

MANY  
POINT  
LAKE

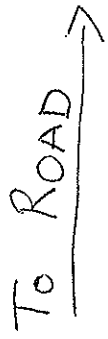
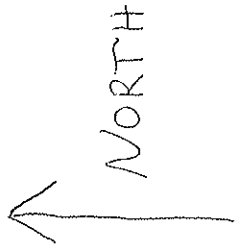

16-18

4-6

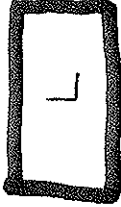

6-8



ROAD

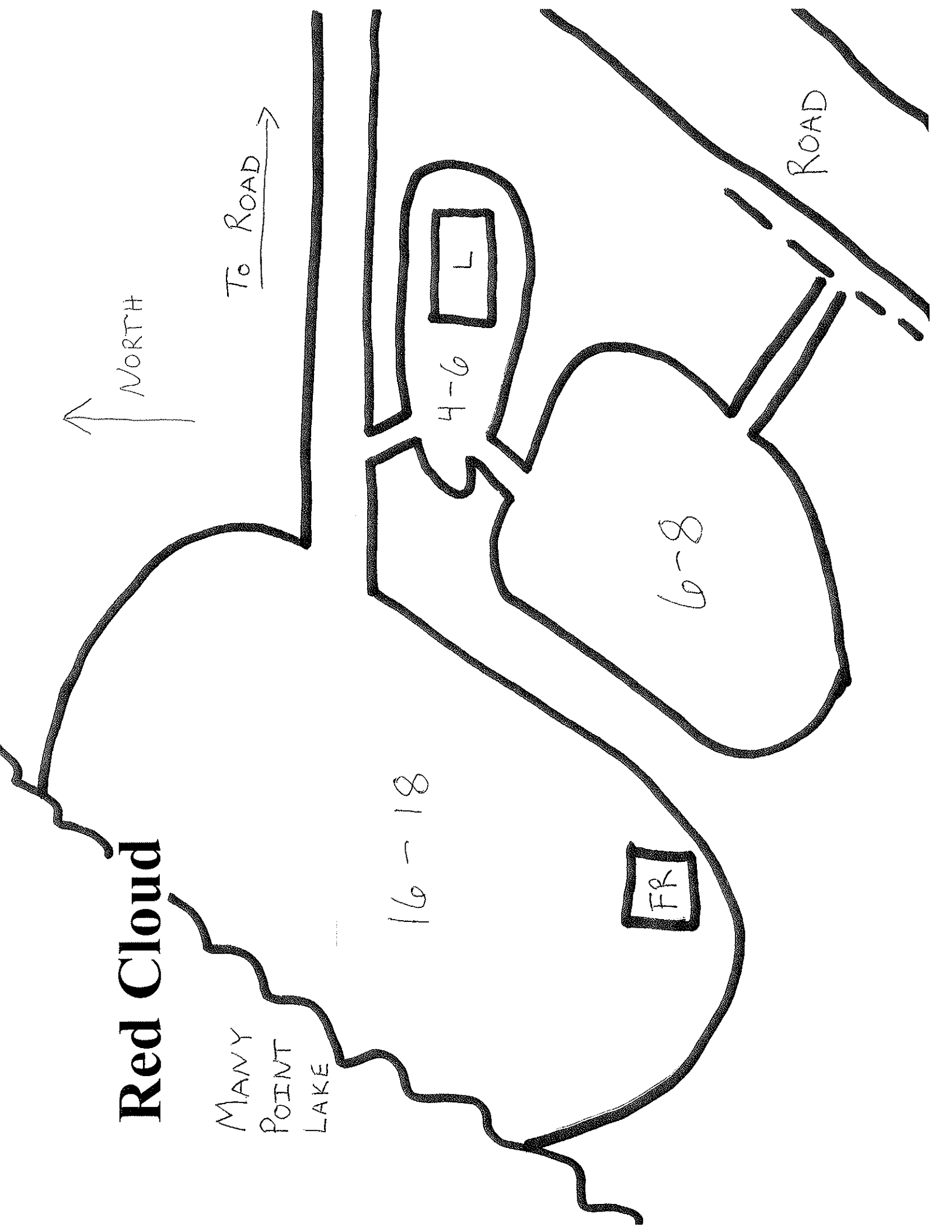



# Roman Nose

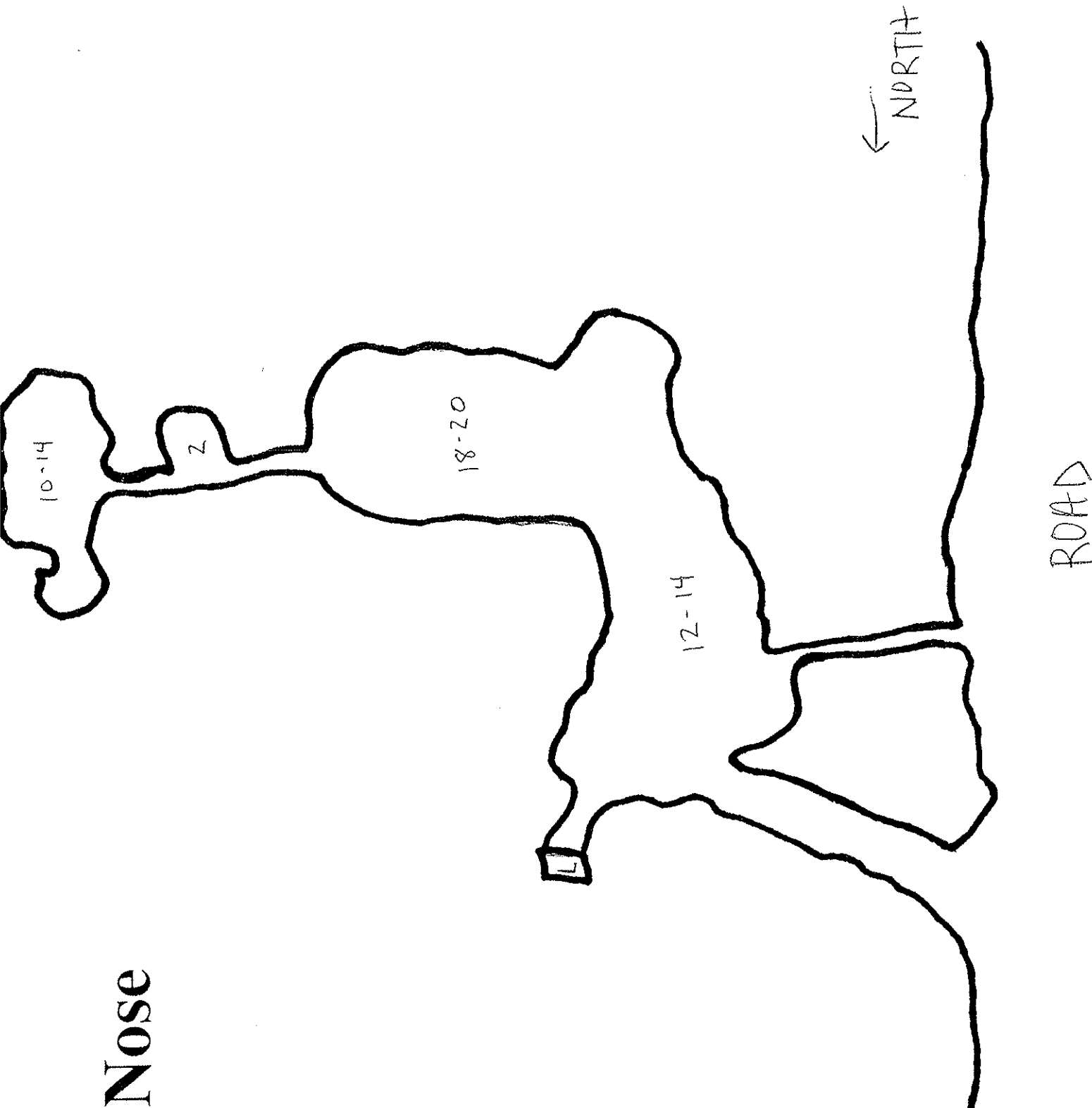

# Samoset

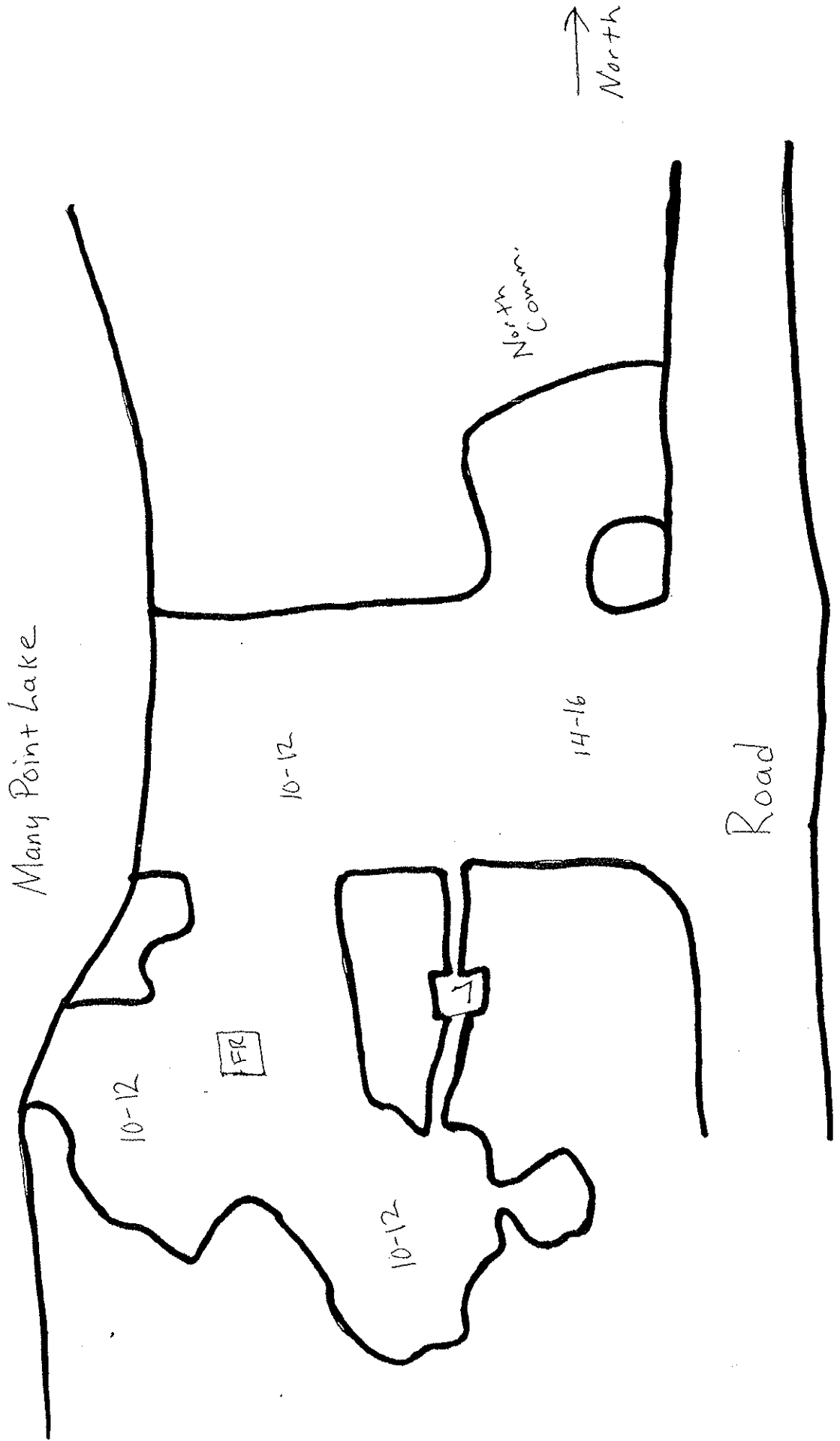

# Sequooyah

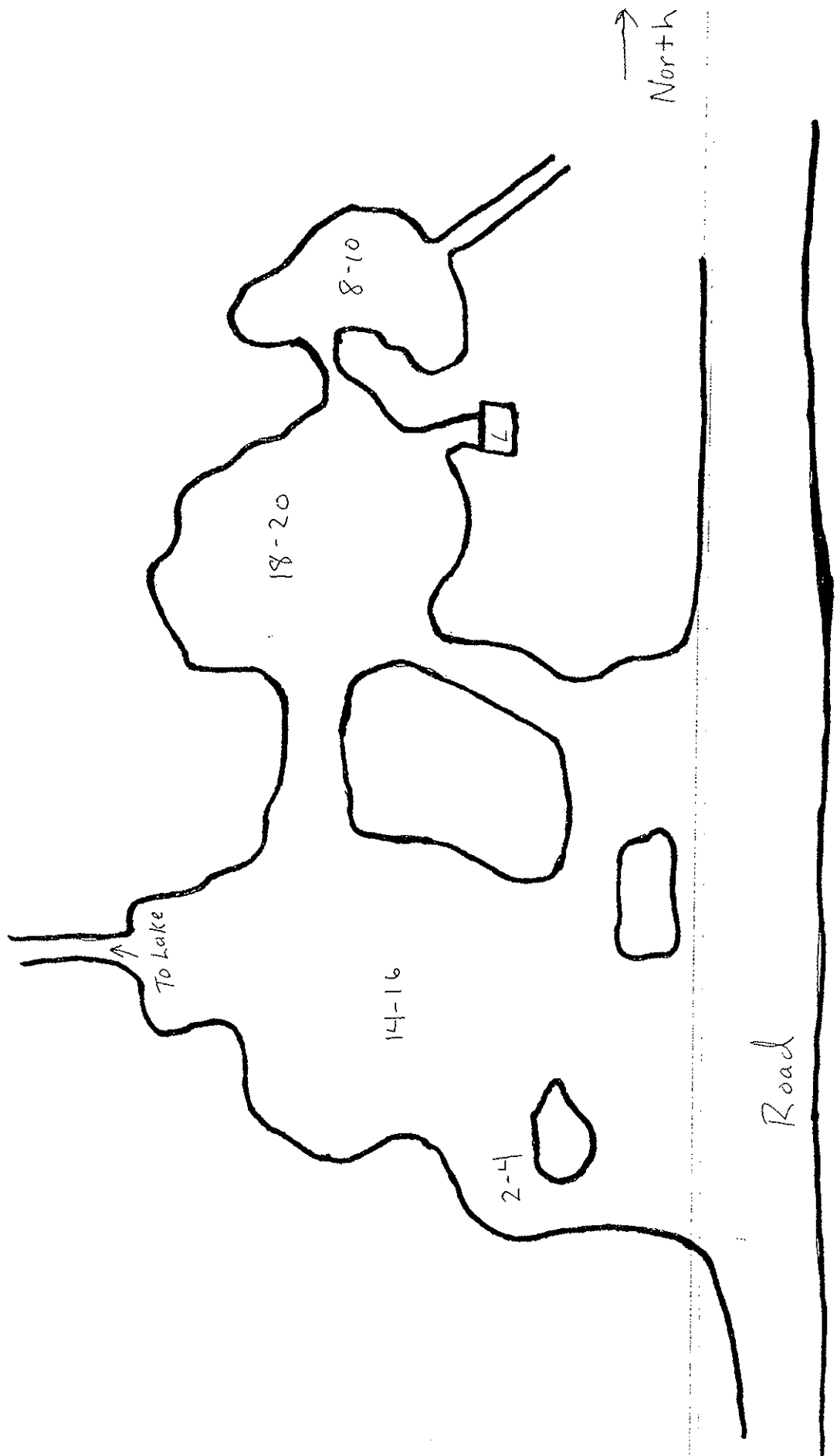

# Skenandoah

Many Point Lake

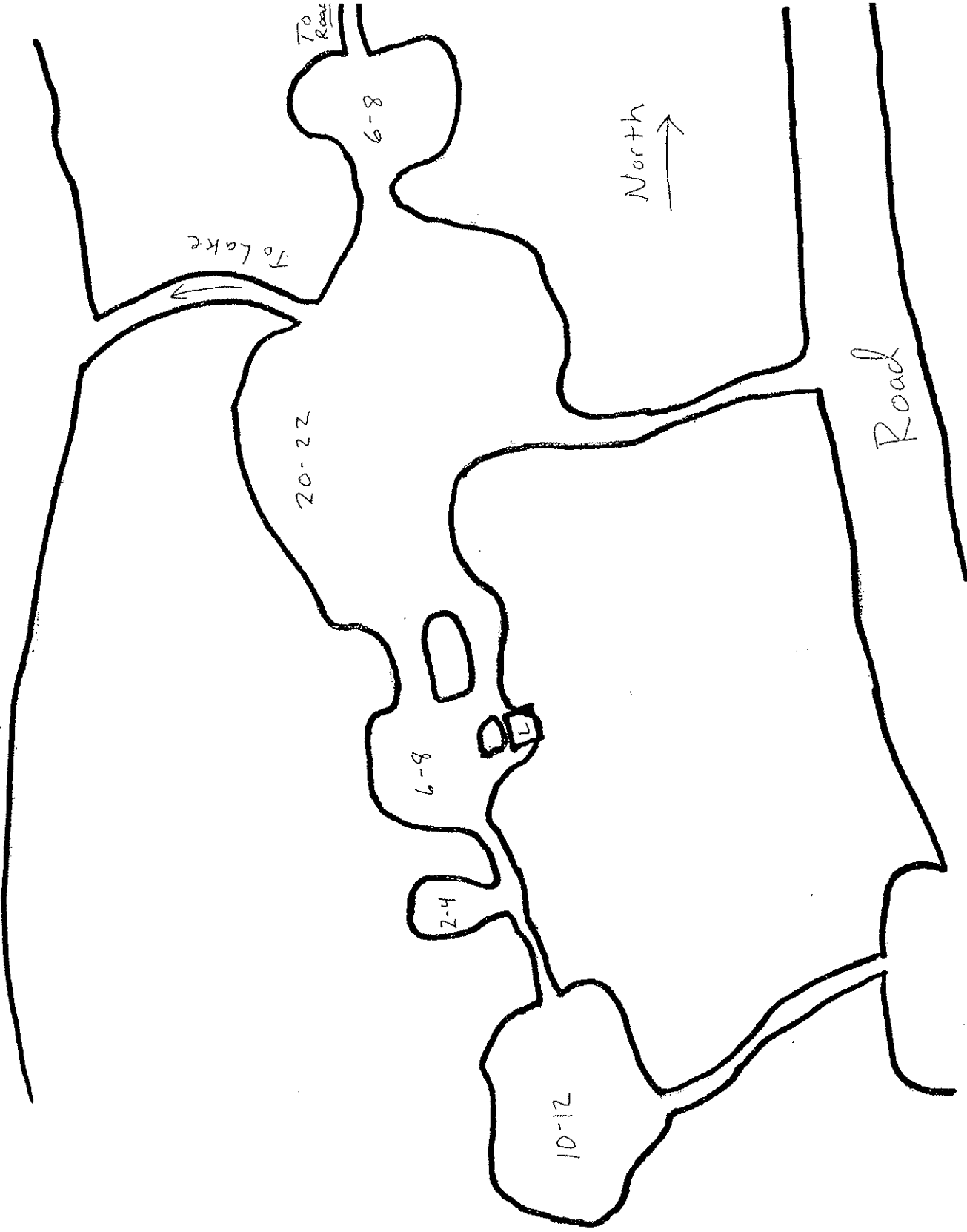

# Tamanend

MANY POINT LAKE

TO LAKE

16-18

4-6

14-16

14-16



NORTH  
↑

ROAD

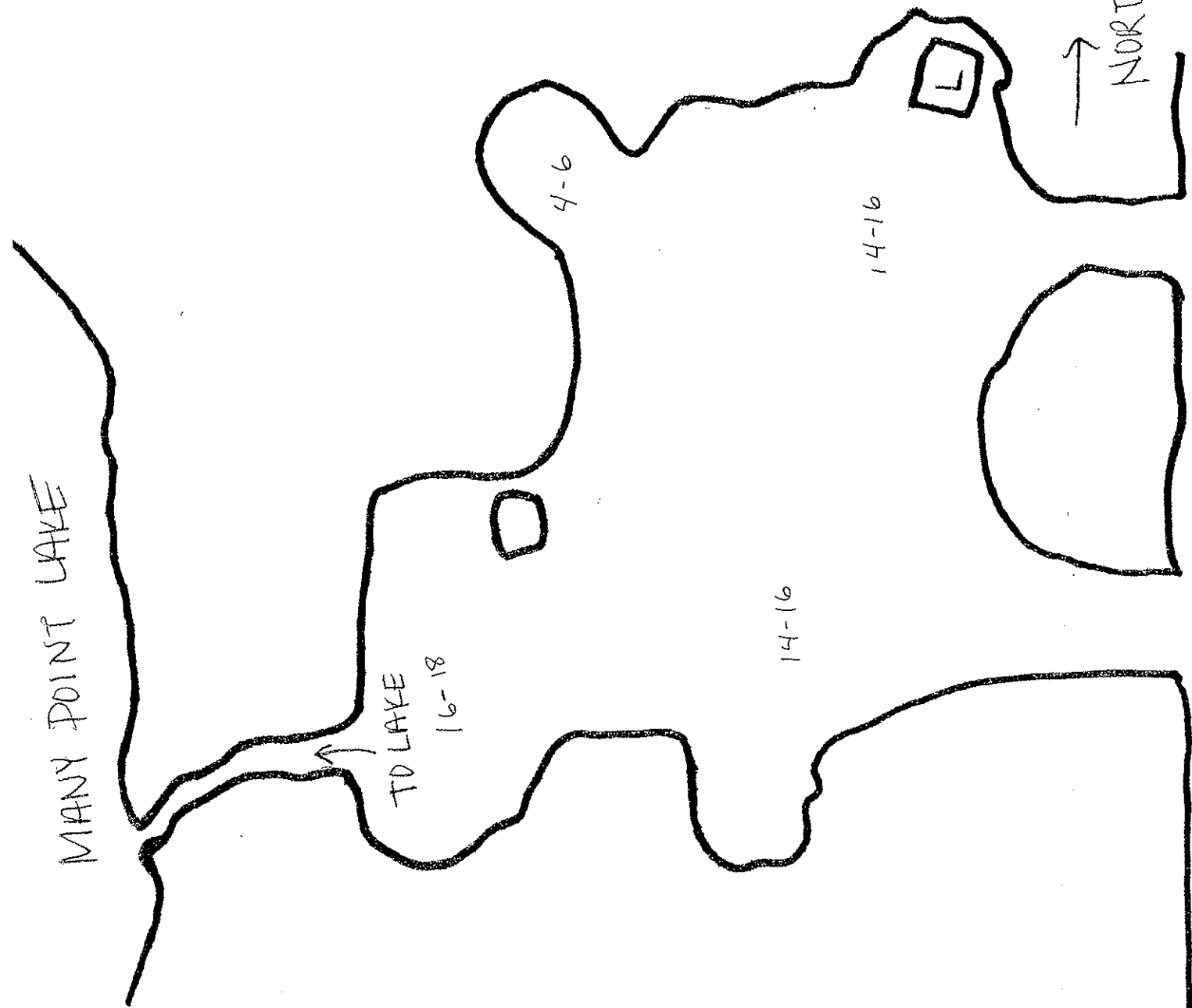

# Taskalusu

Mary Point Lake

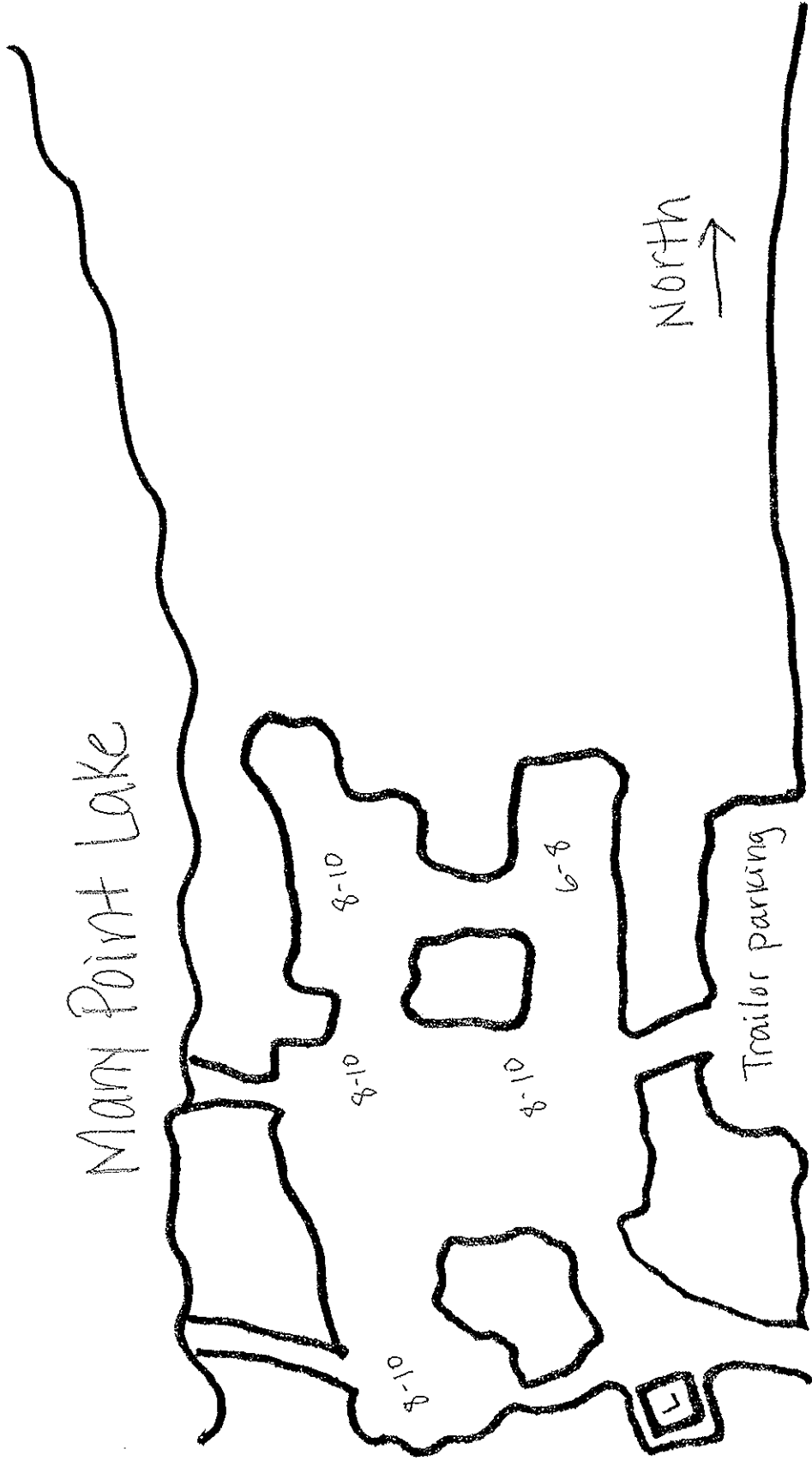

North  
↑

Road